



John Avenue, Greenside, Tyne And Wear, NE40 4RT

*****AVAILABLE NOW***** Living Local is pleased to welcome to the rental market, this lovely two bedroom semi detached home on John Avenue. To the ground floor there is a spacious 'L' shaped kitchen diner with pleasant outlook into the rear garden, separate lounge and downstairs bathroom. To the first floor there is two bedrooms and a white suite W/C. Externally there is a paved driveway and small garden to the front and enclosed lawn garden to the rear. This property is available now on an unfurnished basis. EPC Rating C.



*****AVAILABLE NOW*****

Semi Detached Home

Two Bedrooms

Driveway

Holding Deposit £162

EPC Rating C

Monthly Rental Of £700

Lounge 11' 7" x 11' 1" (3.52m x 3.37m)
Features an electric fire and pleasant outlook to the front garden.

Kitchen/Diner 17' 5" x 14' 2" (5.31m x 4.33m)
'L' shaped open plan kitchen diner with built in wall and base units for storage.

Bathroom 9' 10" x 4' 11" (2.99m x 1.51m)
Features a white suite W/C, Wash Basin, Bath and overhead Shower.

Bedroom 1 14' 8" x 10' 0" (4.48m x 3.05m) Max

Bedroom 2 7' 11" x 7' 10" (2.42m x 2.40m)

W/C 6' 4" x 2' 11" (1.94m x 0.89m)
Features white suite W/C and Wash Basin.

Externally
To the front of the property there is a patio driveway and small garden area with side gated access to the rear enclosed garden. The property is a short walk away from village bus stops and additional on street parking.

Additional Information
Council tax band A. EPC Rating C. Minimum tenancy length 6 months. Holding deposit £162. Security deposit equivalent to 1 months rent. Mobile phone coverage and broadband availability: <https://checker.ofcom.org.uk/>

Holding Deposit
This holding deposit secures the property for you while we conduct your reference checks and goes towards your first months rent prior to move in. It is not an additional fee.

EPC Graph (full EPC available on request)

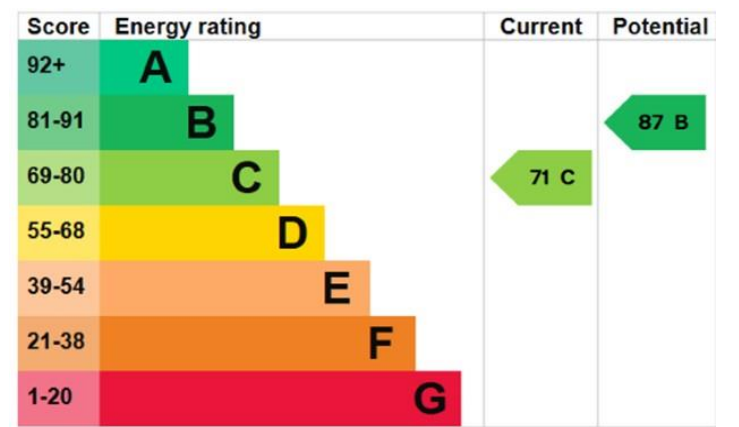

Floorplan

Ground Floor

Approx. 37.7 sq. metres (405.4 sq. feet)

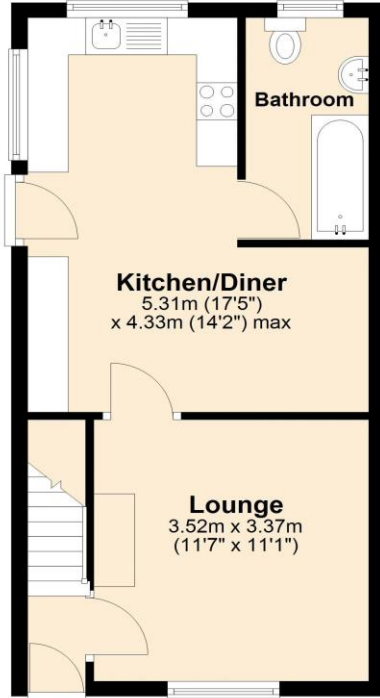

First Floor

Approx. 24.9 sq. metres (268.4 sq. feet)

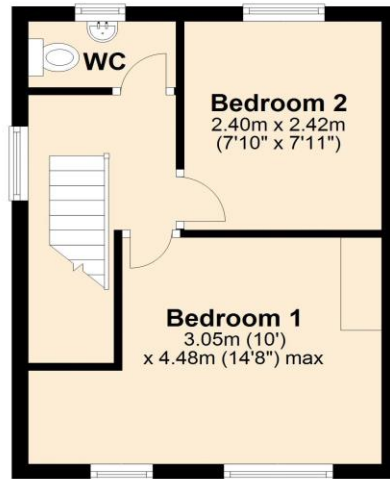

Total area: approx. 62.6 sq. metres (673.7 sq. feet)

For more information please call **0191 414 1200** or email info@livinglocalhomes.co.uk

WE WIN AWARDS year-after-year and are currently ranked in the top 5% for lettings in the country!

Lorraine Valuer & Negotiator

Emma Owner & Managing Director

Laura
Sales & Lettings Negotiator

Brooke
Lettings
Co-ordinator

Louise
Sales & Lettings Negotiator



facebook

PRS
Property
Redress
Scheme

rightmove

OnTheMarket.com

Zoopla.co.uk

PrimeLocation.com

firstmortgage.co.uk®

